



72 SATCHFIELD CRESCENT,
HENBURY, BS10 7BG

**GOODMAN
& LILLEY**



IDEAL FOR FIRST TIME BUYERS AND FAMILIES ALIKE IS THIS MID-TERRACE THREE BEDROOM FAMILY HOME WITH ATTRACTIVE GARDEN AND DRIVEWAY PARKING. THE PROPERTY IS CONVENIENTLY LOCATED FOR THE M4/M5 MOTORWAY LINKS, AIRBUS, SOUTHMEAD HOSPITAL AND A SHORT DRIVE OR STROLL TO THE SHOPS AND AMENITIES OF WESTBURY-ON-TRYM VILLAGE.

Accommodation

Ground Floor

Entrance

Via double glazed entrance door to the main hallway.

Entrance Hallway

Stairs to the first floor and doors to:

Sitting Room

Double glazed window to the front, fitted gas fire, radiator.

Kitchen / Dining Room

A great sized space with both a fitted kitchen area and dining area, double glazed door from the kitchen to the rear garden and two double glazed windows to the rear. Built in under stairs pantry in the kitchen area and radiator.

First Floor

Landing

Loft access and doors to all first floor rooms.

Bedroom One

Double glazed window to the front, built in storage and radiator.

Bedroom Two

Double glazed window to the rear, built in storage and radiator.

Bedroom Three

Double glazed window to the front, radiator.

Shower room

Fitted wet room shower area, low level WC and wash basin, tiled surrounds, double glazed window to the rear.

Outside

Front / Driveway

The front garden now offers driveway parking with steps down to the entrance door.

Rear Garden

There is an attractive rear garden with lawn and patio areas, a block built outside WC and workshop.

-
- Three Bedrooms
 - Driveway Parking
 - Viewing Recommended
 - Mid Terrace Home
 - Attractive Garden
 - Ideal First Home



£227,500



Ground Floor

Approx. 42.3 sq. metres (454.8 sq. feet)

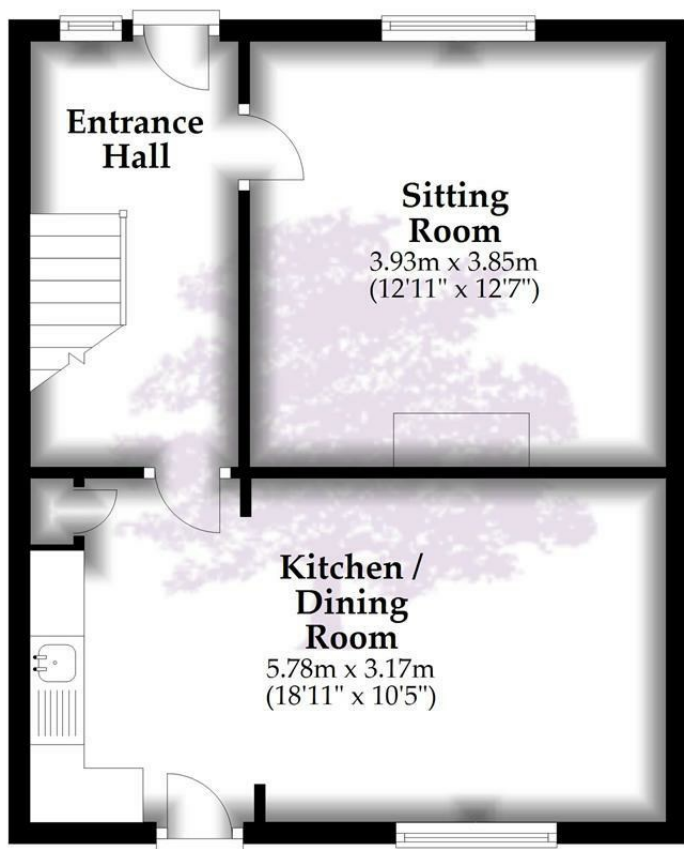

First Floor

Approx. 42.8 sq. metres (460.8 sq. feet)

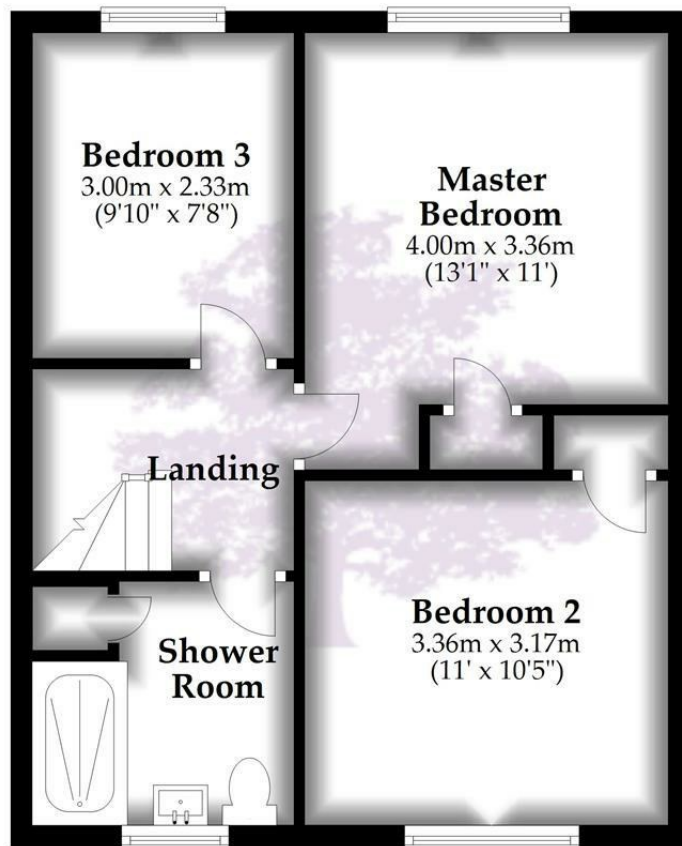

Total area: approx. 85.1 sq. metres (915.7 sq. feet)

HENLEAZE - 0117 2130777

henleaze@goodmanlilley.co.uk

PORTISHEAD - 01275 430440

sales@goodmanlilley.co.uk

SHIREHAMPTON - 0117 2130333

shire@goodmanlilley.co.uk

Zoopla.co.uk

rightmove



WWW.GOODMANLILLEY.CO.UK

These particulars are for general guidance only. They do not form or constitute any part of an offer or contract. Goodman & Lilley has not carried out structural surveys of the property. The services, appliances or specific fittings mentioned in these details have not been tested. Every attempt is made to ensure accuracy, however all photographs, measurements, floor plans and distances are for illustrative purposes only. They must not be relied upon when purchasing carpets and or other fixtures & fittings. Lease details, service charges and ground rents are given as a guide only. They should be checked and confirmed by a licensed solicitor prior to exchange of contracts. The copyright of all details, photographs and floor plans remain exclusive to Goodman & Lilley.